

Vibration Motor VE 6

The sturdy housing is manufactured from aluminium chill casting. The amply dimensioned bearings 6303 2Z C4 are lubricated for life. The centrifugal force can be changed by means of mountable eccentric weights. The vibrator can be run continuously with all the eccentric weights mounted, taking into consideration the admissible power input.

(*exception: type VE 6/2-8 with 40% connection time)

- standard voltage 230/400V · 50Hz
- other voltages available
- protection class IP65 – insulation class F

type	rotational speed upm	centrifugal force N	working moment cm kg	centrifugal force settings		standard voltage 50-60 Hz * V		nominal current A	power input W
				-	8	3 ~	230/400		
VE 6/2	3000	3050	6,1	-	8	3 ~	230/400	0,99 / 0,6	300
VE 6/2-8	3000	4200	8,4	-	11	3 ~	230/400	1,2 / 0,7	350
VE 6/4-11	1500	1430	11,5	-	15	3 ~	230/400	0,75 / 0,43	190
VE 6/4-18	1500	2200	17,8	-	23	3 ~	230/400	0,75 / 0,43	190
VE 6/6	1000	340	6,1	-	8	3 ~	230/400	0,78 / 0,45	150
VE 6/6-18	1000	980	17,8	-	23	3 ~	230/400	0,78 / 0,45	150
VE 6/8	750	190	6,1	-	8	3 ~	230/400	0,54 / 0,31	120
VE 6/8-18	750	550	17,8	-	23	3 ~	230/400	0,54 / 0,31	120

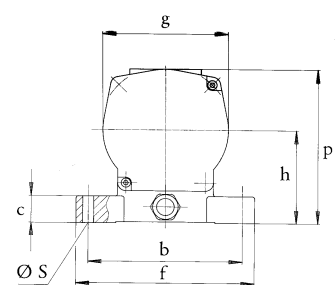
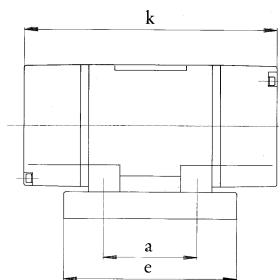

type	mounting dimensions			base dimensions			external dimensions				mass kg
	mm			mm			mm				
	a	b	Ø _S	c	e	f	h	g	p	k	
VE 6/2	65	140	13	25	157	162	86	114	144	230	7,5
VE 6/2-8	80	110	11	25	157	162	86	114	144	270	8,7
VE 6/4-11	124	110	11	25	157	162	86	114	144	270	9,0
VE 6/4-18	80	110	11	25	157	162	86	114	144	320	11,0
VE 6/*	124	110	11	25	157	162	86	114	144	230	8,0
VE 6/*-18	124	110	11	25	157	162	86	114	144	320	11,5

The above given technical performance data are non-binding average values and are subject to modifications and amendments.