

Quick Action Clamps for Formwork Vibrators

Clamps for any formwork type according to customer specifications

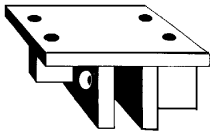

RP: for steel girder formwork with angle profiles and special steel profiles

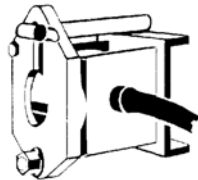

SH: for steel formwork types

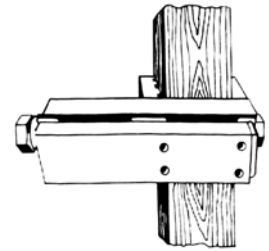

ST: for wooden formwork types



BFD

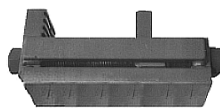

standard

ST

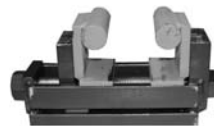

with an adapter for special formwork systems

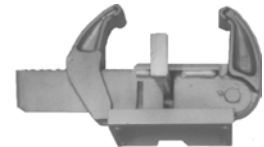

Doka



COMBI

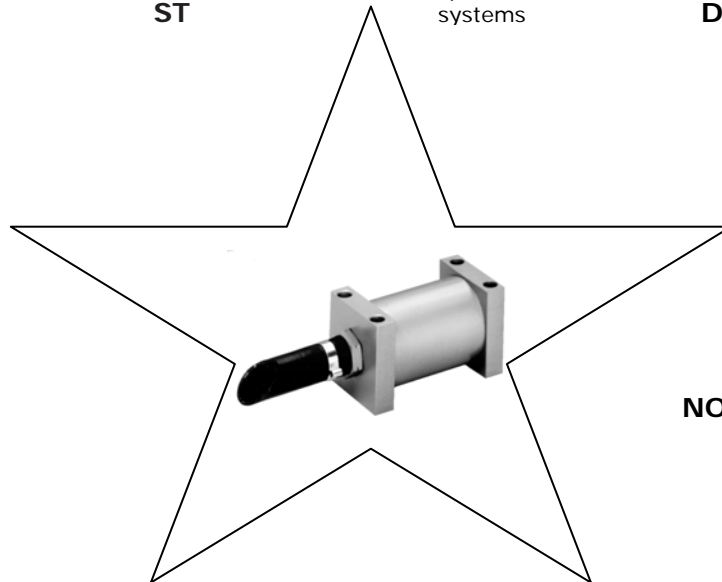

NOE

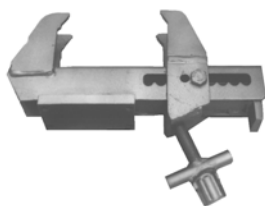

E-Verbinder



REBER

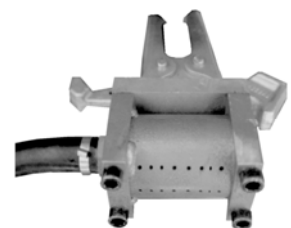

PASCHAL